

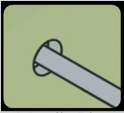

CFS01 Mortar

Applications



Metallic Pipe

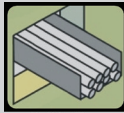

Cable Tray



Insulated Pipe



Plastic Pipe

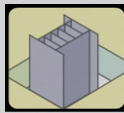

Busway

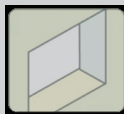

No Penetration

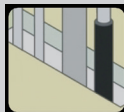

Multiple Penetrations



Description

CFS01 Mortar is an industry leading non-intumescent firestop mortar comprised of a proprietary blend of gypsum and cement. CFS01 Mortar is designed with installation convenience in mind. Our "Variable Viscosity" technology allows the installer to add less water for a thicker consistency or more water for a thinner consistency, depending on the application needs. CFS01 Mortar provides up to 3 hours fire rating to prevent passage of flame, smoke, and toxic fumes.

Per its mix ratios, CFS01 Mortar is the most cost effective mortar solution on the market.

It is typically used to seal mechanical and electrical service penetrations, blank openings and other large annular spaces in fire-resistance rated wall and floor assemblies with ratings up to 3 hour assembly testing.

CFS01 Mortar is non-shrinking, paintable, fast drying, safe, simple to use, halogen and asbestos free. Water and gas impermeable, it offers excellent structural strength while still being re-penetrable and repairable.

Meets the intent of LEED® VOC environmental air quality requirements.

Specifications

Mixing ratio by weight:	(1 part mortar mix: 0.85 - 0.95 part water)
Yield (per 20Kg):	22-25L (1345 in³ - 1525 in³)
Density (after mixing):	1400-1650 kg/m³ (Wet cast)
Drying time:	3 - 4 hours
Time to remove backer (if required):	2 days
Fully cured:	28 days
Application Temperature Range:	40° F - 104° F (5° C - 40° C)
In-Service Temperature:	-13° F - 176° F (-25° C - 80° C)
Packing:	20Kgs/Bag
Shelf Life:	3 years, when stored indoors in dry conditions in original unopened packaging

Fill, void or cavity material.
For use in through-penetration
firestop and joint systems.



CFS01 Mortar

Testing

ASTM E 814 up to 3 hr F and T Rating

UL 1479 3 hr F and T Rating

L Rating at Ambient - Less than 1 cfm/sq. ft.

GB 23864

CAN/ULC S-115 up to 3 hr FTH Rating

L Rating at Ambient - Less than 5.1 L/S/m²

Installation guide:

1. Refer to applicable certification directory or www.painttoprotect.com for listed assemblies.
2. Clean surfaces of the opening and all penetration items to ensure adhesion. Opening must be dry, frost free and void of any grease and dust.
3. An appropriate backer must be installed first, as per Listed system, cut to fit below the opening to support the mix until it cures.
4. Mix with clean potable water in a proper container according to the mixing ratio (1 parts mortar mix: 0.85 - 0.95 part water), slowly adding the mortar into water while stirring by power mixer to ensure a smooth lump-free mix (Note: Do not add water into mortar). Mix well for 30-40 seconds. The wet mixture is best poured into the floor opening within 3 minutes after mixing.
5. Pour the wet mix into the opening, allowing for the proper depth of fill materials. If the first pouring depth is not sufficient, add more wet mix after the mortar is set.
6. Remove the backer after the mix has set if it is combustible. Noncombustible backers may remain in place.
7. Clean all tools and mixing containers with water immediately after using.



International Fireproof Technology Inc.
The Ultimate in Firestop Solutions and Fire Protective Coatings

International Fireproof Technology, Inc.
17528 Von Karman Ave. Irvine, CA 92614

Office: 949-975-8588
Web Site: www.painttoprotect.com
Email: ptp@painttoprotect.com